

GET | PRODUCT MANUAL

CONSTRUCTION EQUIPMENT EXCAVATORS



HITACHI

Reliable solutions

MACHINE: ZX17U-5

DESCRIPTION	PART No.	WEIGHT KG	DATA SHEET	COMMENTS
Adapter	MA02DL	1.40	MB-9624	Straight only 13mm lip plate
Point Standard	MT02S	1.50	MB-9625	
Point Sabre	MT02ST	1.72	MB-9625	
Retainer Roll Pin	10mmx45mm			Unbrako Sel-Loc Roll Pin
Sidecutter	MS4095	5.50	MB-9828	
Heel Shroud (option)	KC170BHS	7.70	MB-9664	See flyer for more options

MACHINE: ZX17U-5, ZX26U-5, ZX33U-5 & ZX38U-5

DESCRIPTION	PART No.	WEIGHT KG	DATA SHEET	COMMENTS
Adapter	MA02FM	1.40	MB-9624	Straight only 16mm lip plate
Point Standard	MT02S	1.50	MB-9625	
Point Sabre	MT02ST	1.72	MB-9625	
Retainer Roll Pin	10mmx45mm			Unbrako Sel-Loc Roll Pin
Sidecutter	MS4095	5.50	MB-9828	
Sidecutter (Keech)	SC76R/L	2.00		For ZX17 & ZX38
Heel Shroud (option)	KC170BHS	7.70	MB-9664	See flyer for more options

MACHINE: ZX48U-5, ZX55U-5 & ZX65USB-5

DESCRIPTION	PART No.	WEIGHT KG	DATA SHEET	COMMENTS
Adapter T3	MA03	2.00	MB-9601	Straight only 20mm lip plate
Point Standard	MT03S	1.10	MB-9602	
Point Sabre	MT03ST	1.50	MB-9602	
Retainer Pin	RP-A03	0.10	MB-9657	
Retainer Insert	RI-A03	0.10	MB-9657	
Sidecutter	MS4095	5.50	MB-9828	
Sidecutter (Keech)	SC76R/L	2.00		For ZX48 & ZX65
Heel Shroud (option)	KC170BHS	7.70	MB-9664	See flyer for more options

MACHINE: ZX48U-5, ZX55U & ZX65USB-5

RIPPER FITMENT - MAXIMUM MACHINE BREAKOUT FORCE 37.3 KN

DESCRIPTION	PART No.	WEIGHT KG	DATA SHEET	COMMENTS
Weld on Nose	2A-30-4	4.60	MB-9670	Use Retainer Pin RP-N3M
Ripper Point	2100 2100HD	3.00 7.30	MB-9672 MB-9672	

MACHINE: ZX75U-5 & ZX85USB-5

DESCRIPTION	PART No.	WEIGHT KG	DATA SHEET	COMMENTS
Adapter T3	MA04	2.90	MB-9601	Straight only 25mm lip plate
Point Standard	MT04S	1.50	MB-9602	
Point Sabre	MT04ST	1.72	MB-9602	
Retainer Roll Pin	RP-A03	0.10	MB-9657	
Retainer Insert	RI-A03	0.10	MB-9657	
Sidecutter left hand	MS04L	7.10	MB-9603	¾” bolts 3 off
Sidecutter right hand	MS04R	7.10	MB-9603	¾” bolts 3 off
Heel Shroud (option)	KC170BHS	7.70	MB-9664	See flyer for more options

MACHINE: ZX75U-5 & ZX85USB-5

RIPPER FITMENT - MAXIMUM MACHINE BREAKOUT FORCE 53.3 KN

DESCRIPTION	PART No.	WEIGHT KG	DATA SHEET	COMMENTS
Weld on Nose	2A-30-101	4.50	MB-9668	Use Retainer Pin RP-N7
Ripper Point	101B 101B-HD 101B-HP	5.75 7.30 7.70	MB-9669 MB-9669 MB-9669	

MACHINE: ZX130-5, ZX130US-5 & ZX160LC-5

DESCRIPTION	PART No.	WEIGHT KG	DATA SHEET	COMMENTS
Adapter T3	MA07	4.60	MB-9601	Straight only 32mm lip plate
Point Standard	MT07S	2.90	MB-9602	
Point Sabre	MT07ST	2.85	MB-9602	
Retainer Roll Pin	RP-A07	0.20	MB-9657	
Retainer Insert	RI-A07	0.10	MB-9657	
Sidecutter left hand	MS07L	9.30	MB-9604	7/8” bolts 4 off
Sidecutter right hand	MS07R	9.30	MB-9604	7/8” bolts 4 off
Heel Shroud (option)	KC170BHS	7.70	MB-9664	See flyer for more options

MACHINE: ZX130-5, ZX130US-5 & ZX160LC-5

RIPPER FITMENT - MAXIMUM MACHINE BREAKOUT FORCE 102 KN

DESCRIPTION	PART No.	WEIGHT KG	DATA SHEET	COMMENTS
Weld on Nose	2A-30-6	10.00	MB-9670	Use Retainer Pin RP-N7
Ripper Point	2101 2101HD	6.45 7.25	MB-9672 MB-9672	



MACHINE: ZX200-5, ZX210LC-5, ZX225US-5 & ZX225USLC-5

DESCRIPTION	PART No.	WEIGHT KG	DATA SHEET	COMMENTS
Adapter T3	HA32-142S	10.50	MB-9863	Straight only 32mm lip plate
Point Standard	HT142S	5.82	MB-9863	
Point Rock Penetration	HT142RP	5.48	MB-9863	
Point Sabre	HT142ST	5.89	MB-9863	
Clip Assembly	MSLP-02	0.13	MB-9809	
Sidescutter left hand	MS09L	13.30	MB-9605	1" bolts 6 off
Sidescutter right hand	MS09R	13.30	MB-9605	1" bolts 6 off
Heel Shroud (option)	YA00034320	28.10	MB-9815	See flyer for more options

MACHINE: ZX200-5, ZX210LC-5, ZX225US-5, ZX225USLC-5, ZX250-5, ZX260LC-5 & 290LC-5

RIPPER FITMENT - MAXIMUM MACHINE BREAKOUT FORCE 167 KN

DESCRIPTION	PART No.	WEIGHT KG	DATA SHEET	COMMENTS
Weld on Nose	2102SL-WN	18.30	MB-9857	Sidelock Clip MSLP-04. MB-9856
Ripper Point	2102SL	16.60	MB-9857	Fitting instruction. FIH-048

MACHINE: ZX250-5, ZX260LC-5 & ZX290LC-5

DESCRIPTION	PART No.	WEIGHT KG	DATA SHEET	COMMENTS
Adapter Sidelock	HA40-154S	14.00	MB-9855	Straight only 40mm lip plate
Point Standard	HT154S	10.40	MB-9855	
Point Rock Penetration	HT154RP	9.40	MB-9855	
Point Sabre	HT154ST	9.60	MB-9855	
Clip Assembly	MSLP-04	0.22	MB-9856	Fitting instruction. FIH-048
Lip Shroud (option)	HLS4050-1000		MB-9832	Weld on, cut length to suit
Sidescutter left hand	MS11L	19.00	MB-9606	1" bolts 6 off
Sidescutter right hand	MS11R	19.00	MB-9606	1" bolts 6 off
Heel Shroud (option)	YA00034320	28.10	MB-9815	See flyer for more options

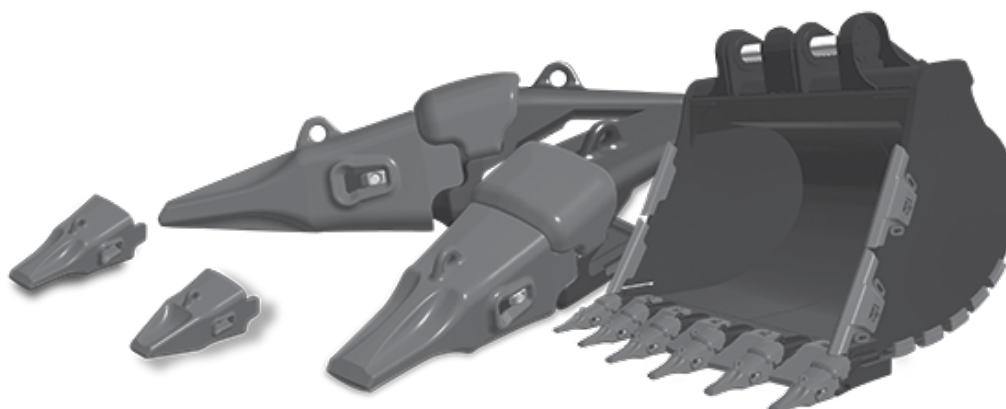

MACHINE: ZX350-5 & ZX360LC-5

DESCRIPTION	PART No.	WEIGHT KG	DATA SHEET	COMMENTS
Adapter Sidelock	HA50-164S	18.00	MB-9854	Straight only 50mm lip plate
Point Standard	HT164S	12.40	MB-9854	
Point Rock Penetration	HT164RP	11.20	MB-9854	
Point Sabre	HT164ST	11.10	MB-9854	
Clip Assembly	MSLP-04	0.22	MB-9856	Fitting instruction. FIH-048
Lip Shroud (option)	HLS4050-1000		MB-9832	Weld on, cut length to suit
Sidescutter (option)	MS700-40	49.00	MB-9786	1¼" x 5½" Lg Plow Bolts 1¼" Nyloc Nut
Heel Shroud (option)	YA00034320	28.10	MB-9815	See flyer for more options

MACHINE: ZX350-5, ZX360LC-5, ZX490LCH-5, ZX690LCH-5 & ZX890LCH-5

RIPPER FITMENT - MAXIMUM MACHINE BREAKOUT FORCE 233 KN

DESCRIPTION	PART No.	WEIGHT KG	DATA SHEET	COMMENTS
Weld on Nose	2103SL-WN	22.40	MB-9858	Sidelock clip MSLP-04. MB-9856
Ripper Point	2103SL	21.90	MB-9858	Fitting instruction. FIH-048

MACHINE: ZX490LCH-5

DESCRIPTION	PART No.	WEIGHT KG	DATA SHEET	COMMENTS
Adapter Sidelock	HA50-174S	25.00	MB-9831	Straight only 50mm lip plate
Point Standard	HT174S	13.70	MB-9831	
Point Rock Penetration	HT174RP	14.60	MB-9831	
Point Sabre	HT174ST	13.60	MB-9831	
Clip Assembly	MSLP-04	0.22	MB-9856	Fitting instruction. FIH-048
Dirt Plug	SLDP174	0.02	MB-9900	
Lip Shroud (option)	HLS4050-1000		MB-9832	Weld on, cut length to suit
Sidescutter (option)	MS700-40	49.00	MB-9786	1¼" x 5½" Lg Plow Bolts 1¼" Nyloc Nut
Heel Shroud (option)	YA00034320	28.10	MB-9815	See flyer for more options



MACHINE: ZX690LCH-5 & ZX890LCH-5

DESCRIPTION	PART No.	WEIGHT KG	DATA SHEET	COMMENTS
Adapter Sidelock 70mm General Purpose	MA70-205S	49.80	MB-9783	Left & right hand available
Adapter Sidelock 80mm Heavy Duty / Rock	MA80-205S	49.80	MB-9783	Left & right hand available
Point Rock Penetration	MT205HP	25.80	MB-9784	
Point General Purpose Long	MT205GPL	26.80	MB-9784	
Point Rock Penetration	MT205RP	24.60	MB-9784	
Clip Assembly	YA00051937	0.90	MB-9869	Fitting instruction. FIH-013
Lip Shroud Weld on (option) 225 wide	MLS7080S	22.60	MB-9785	Left & right hand available
Lip Shroud Weld on (option)	HLS4050-1000	22.60	MB-9832	Weld on, cut length to suit
Sidecutter (option)	MS700-40	49.00	MB-9832	1¼" x 4½" Lg Plow Bolts 1¼" Nyloc Nut
Heel Shroud (option)	YA00034320	28.10	MB-9815	See flyer for more options



↑
GENERAL PURPOSE
LOW ABRASION

↑
HEAVY DUTY
HIGH ABRASION

HITACHI

ZX-5 SERIES EXCAVATORS

Superior operator comfort, new levels of efficiency, reliability and power.
The range of features lead to exceptional productivity.

LEADING THE WAY



HITACHI

Reliable solutions



1300 HITACHI
HCMA.COM.AU

BRANCHES

- > **Sydney** (Corporate Support Group)
3/1 Foundation Pl, Pemulwuy, NSW 2145
P 02 8863 4800 F 02 8863 4899
- > **Brisbane** (Corporate Support Group)
121 Coulson St, Wacol, QLD 4076
P 07 3423 5600 F 07 3423 5699
- > **Adelaide**
Port Wakefield Rd, Cavan, SA 5094
P 08 8360 5300 F 08 8260 6580
- > **Brisbane**
539 Boundary Rd, Archerfield, QLD 4108
P 07 3276 4500 F 07 3216 7866
- > **Bunbury**
53 Halifax Dr, Davenport, WA 6230
P 08 9724 8300 F 08 9725 7581
- > **Canberra**
Unit 15, 157-161 Gladstone St,
Fyshwick, ACT 2609
P 02 6239 1438 F 02 6239 1782
- > **Dalby**
17728 Warrego Hwy, Dalby, QLD 4405
P 07 4669 6712 F 07 4669 7445
- > **Darwin**
20 Verrinder Rd, Berrimah, NT 0828
P 08 8942 7800 F 08 8942 7899
- > **Emerald**
56 Gregory Hwy, Emerald, QLD 4720
P 07 4980 6800 F 07 4987 6379
- > **Gunnedah**
27 Law Close, Gunnedah, NSW 2380
P 02 6743 4654
- > **Kalgoorlie**
48-50 Percy Rd, West Kalgoorlie, WA 6430
P 08 9025 2400 F 08 9025 2499
- > **Launceston**
9-15 Pembury Pl, Rocherlea, TAS 7248
P 03 6326 3435 F 03 6326 5916
- > **Mackay**
12-20 Southgate Dr, Paget, QLD 4740
P 07 4952 6800 F 07 4952 6900
- > **Melbourne**
240-248 Frankston-Dandenong Rd,
Dandenong, VIC 3175
P 03 9791 6666 F 03 9791 8114
- > **Muswellbrook**
27-35 Thomas Mitchell Dr,
Muswellbrook, NSW 2333
P 02 6541 6300 F 02 6541 6399
- > **Newcastle**
1 Balook Dr, Beresfield, NSW 2322
P 02 4964 4550 F 02 4966 8021
- > **Perth**
107 Allen Rd, Forrestdale, WA 6112
P 08 9234 9800 F 08 9234 9990
- > **Port Hedland**
1/119 Iron Ore St, Wedgefield, WA 6721
P 08 9172 6800 F 08 9172 6899
- > **Somerton**
130 Hume Hwy, Somerton, VIC 3062
P 03 9303 6700 F 03 9303 6799
- > **Sydney**
51 Milperra Rd, Revesby, NSW 2212
P 02 9780 6900 F 02 9780 6999
- > **Tom Price**
32 Boonderoo Rd, Tom Price, WA 6751
P 08 9188 2390 F 08 9188 2323
- > **Townsville**
22-24 Duckworth St, Townsville, QLD 4814
P 07 4727 5100 F 07 4727 5199
- > **Whyalla**
9 Oborn St, Whyalla Norrie, SA 5608
P 08 8360 5300 F 08 8260 6580

For more information please contact your local
Hitachi Construction Machinery branch or visit:

www.hcma.com.au

HITACHI

